

# Trike 3000

## technical specifications

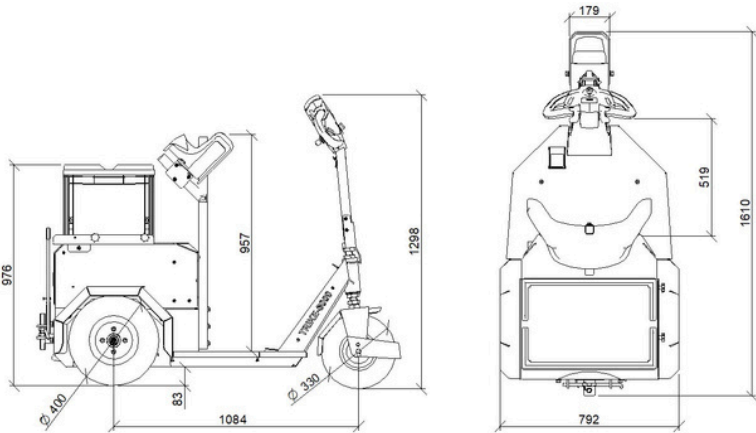

<b>Manufacturer</b>	Metazet B.V.
<b>Turning circle</b>	2200 mm
<b>Water tightness</b>	IP21
<b>Nominal tensile force</b>	52.3 N
<b>Towing weight</b>	250 Kg [according to VDI 2198]
<b>Vehicle weight (excl. battery)</b>	120.5 Kg
<b>Material</b>	Steel
<b>After treatment</b>	Powdercoating
<b>Max forward speed (turtle) / eco</b>	8.3 Km/h
<b>Max. forward speed (hare)</b>	12 Km/h
<b>Max. speed reverse (turtle) / eco</b>	4.8 Km/h
<b>Max. speed backwards (hare)</b>	8.5 Km/h
<b>Time to reach max. speed</b>	3 sec
<b>Pallet dimensions</b>	1500 x 800 mm
<b>Motor type</b>	DC motor
<b>Driver</b>	Transaxle
<b>Power</b>	400 W
<b>Battery type</b>	Lithium [NMC]
<b>Battery voltage</b>	24 V
<b>Battery capacity</b>	40 Ah
<b>Battery weight</b>	11 Kg
<b>Battery charger type</b>	IEB
<b>Battery charger input voltage</b>	110/230 V
<b>Battery charger output voltage</b>	24 V
<b>Battery charger output power</b>	8 A
<b>Controls</b>	Programable DC controller
<b>Control max. voltage</b>	24 V
<b>Control max. power</b>	180 A
<b>Max. driver weight</b>	125 Kg
<b>Load bearing capacity (evenly distributed)</b>	40 Kg
<b>Brakes, rear</b>	Electric brake



**metazet™**

**TECRAM**

Route d'Yverdon 34 · CH-1373 Chavornay · +41 24 441 42 40 · info@tecrum.ch · www.tecrum.ch

[metazet.com](http://metazet.com)